

Setup Instructions

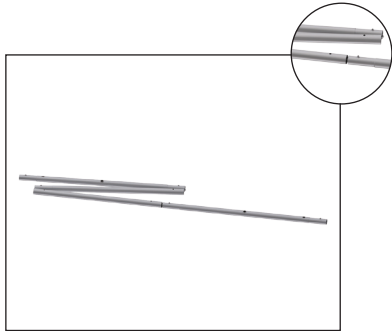

1. Start connecting the different sections of the frame by pushing the ends together.

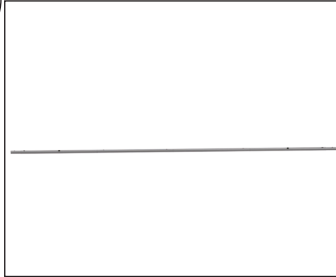

2. There are 4 lengths that you need to pre assemble.

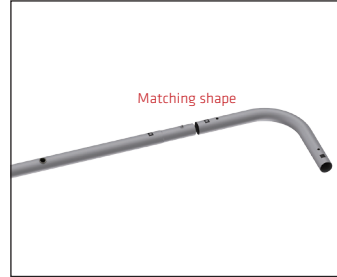

3. Frame ends have a code shape that needs to match.

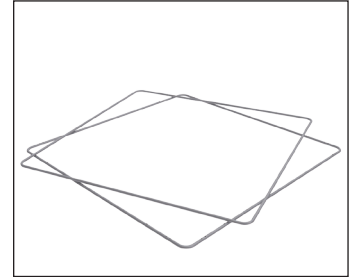

4. Bring the rings together making sure that the wholes face each other.



5. Place the Black vertical shafts in the bottom ring.



6. Then the other end in the top ring.



7. Now using some force connect the sections together.

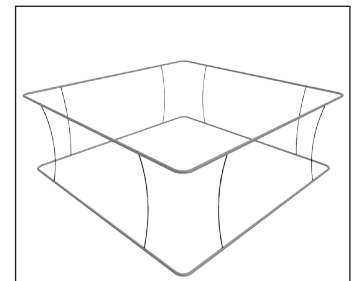

8. Repeat 5.6.7 till all assembled.

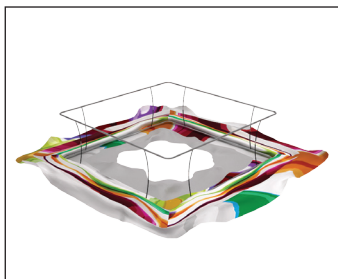

9. Put the erected frame on top of the fabric print.



10. Start lifting the fabric and close the zipper, please note eyelet whole should mach vertical pole.

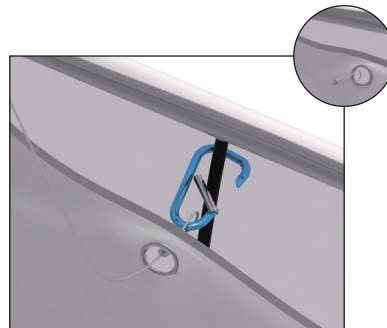

11. Thread your cable through the eyelet and continue to next section.

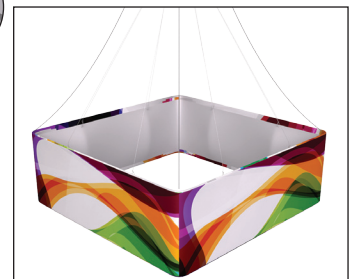

12. Connect all cables to a single hook and your ready to hang it.