

Curved Pop Up Assembly

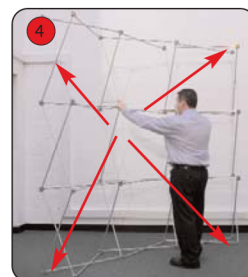

Kit: Mag Bars, frame, end-cap Graphics x 2 and Front and/or rear graphics

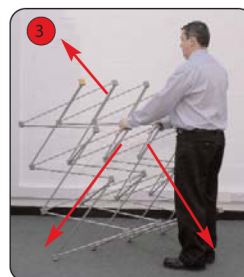

Take the frame, ensuring that the coloured nodes are at the top. Stand the frame on the floor (2) and open up (3) until the locking arms click the frame securely into place (4)

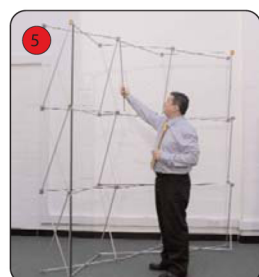

Add the mag bars onto the system for front, end-cap and if applicable, the rear.

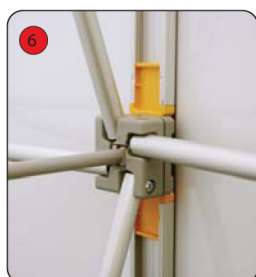

Ensure that the mag bars lock onto the magnetic pip securely.

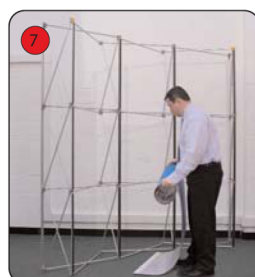

Unwrap each graphic carefully and attach to the system.



Carefully hook the top hanger onto the top node on each side of the quad.



Smooth the graphic onto the mag bars, ensuring that it sits flat and is aligned to the centre line of each mag bar.

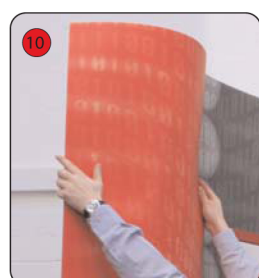

Repeat for the end-cap, ensuring that the fit is correct.

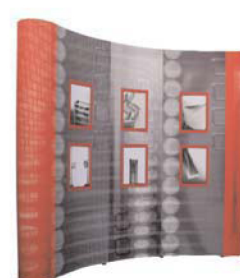

IMPORTANT - when putting graphics away, ALWAYS roll with printed side OUT